

CITY WALK

C R E S T L A N E

presented by Canaletto Sky Real Estate LLC

IHR DEUTSCHER IMMOBILIENMARKLER INKLUSIVE RECHTSBERATUNG IN DUBAI !



ERWERBEN SIE PROVISIONSFREI DIREKT VOM BAUTRÄGER

CANALETTO SKY
REAL ESTATE

DIVE INTO



At City Walk Crestlane, every corner pulses with energy, and every moment invites you to embrace the beat of the city and the calm of waterside living, creating an experience as dynamic and unique as you are. It's a new vibe. It's a new space. It's a new story.

THE CITY'S RHYTHM



LET WATER SHAPE

Water isn't just a feature at City Walk Crestlane, it's the essence of this masterfully designed community. Every building faces the water, making it the first thing you see, and the last thing you think about.

From tranquil reflections to gentle ripples, water flows through every corner of the community, creating an atmosphere of movement and connection. Whether you're sitting back to enjoy the view, taking a refreshing dip, or gliding through its depths, here, the water draws you into its rhythm.



THE CITY'S BEAT

NEW BEATS MEET ICONIC STREETS

City Walk Crestlane offers seamless access to Dubai's most iconic landmarks and destinations. Just 10 minutes from the pristine shores of Jumeirah Beach and 5 minutes from the vibrant energy of Downtown Dubai, this prime location connects you to the city through major highways and road networks.

From breathtaking views of Dubai's glittering skyline to the tranquil expanse of the Arabian Gulf, this is a home where the best of both worlds meet. Here, city energy merges with peaceful, refreshing spaces, placing everything you love within reach, right in the heart of City Walk.

2
MINUTES FROM
CITY WALK MALL

3
MINUTES FROM
SHEIKH ZAYED ROAD

7
MINUTES FROM
JUMEIRAH BEACH

7
MINUTES FROM
DUBAI MALL

CITY WALK CRESTLANE



EVERY CORNER SPEAKS

URBAN PULSE



01 - WATER FEATURES
02 - SWIMMING POOLS
03 - SPORTS COURTS
04 - KIDS' PLAY AREAS

05 - JOGGING TRACKS
06 - CYCLING TRACKS
07 - OUTDOOR FITNESS STATIONS
08 - COMMUNITY HUBS

09 - EVENT LAWNS
10 - YOGA AND EXERCISE LAWNS
11 - LAWNS WITH SEATING SPACE
12 - SUNKEN SEATS

13 - WATER CINEMA
14 - PET PARK

A modern, multi-story residential building with a swimming pool and lush landscaping. The building features large glass windows and balconies with plants. The pool is in the foreground, and there are palm trees and other greenery around it. The sky is clear and blue.

NEW
ENERGY

ENDLESS
POSSIBILITIES

TRAINING STUDIO

The Cardio Space fuels high-energy workouts with cutting-edge equipment, all set against the serene water view. Meanwhile, the Weights Area is designed to push your limits, featuring the latest fitness tech in a space built for strength and power.





YOGA STUDIO



The Yoga Studio is your calm within the storm—a serene escape where panoramic glass walls frame tranquil water views, inviting you to unwind, breathe, and find your balance in perfect harmony.

COLLABORATIVE SUITE



The Collaborative Suite isn't just a workspace—it's the perfect fusion of productivity and peace, featuring modern workstations and expansive windows with uninterrupted water views to keep your creativity flowing and your vibe perfectly balanced. This space also offers a library, providing a quiet retreat for reading when you need a break, making it the ideal environment to focus, collaborate, and create.



SWIMMING POOLS



Dive into the refreshing waters, featuring infinity pools, beach-style pools, and dedicated kids' pools. Each space offers the perfect setting for residents to swim, relax, and enjoy quality time with family in a peaceful, resort-style atmosphere.

WATER FEATURES

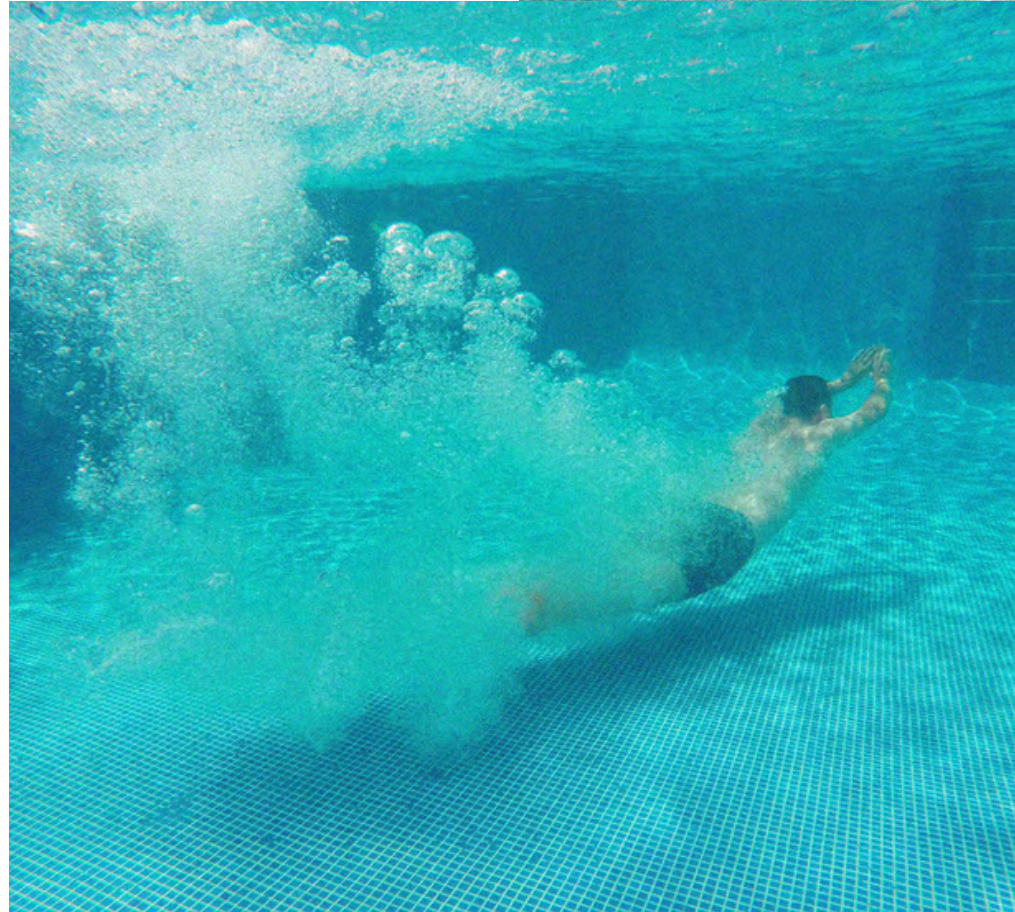

Embrace the community's
ambiance, enhanced by
stunning cascading water
features that set a calming
tone and invite relaxation
and tranquillity throughout.

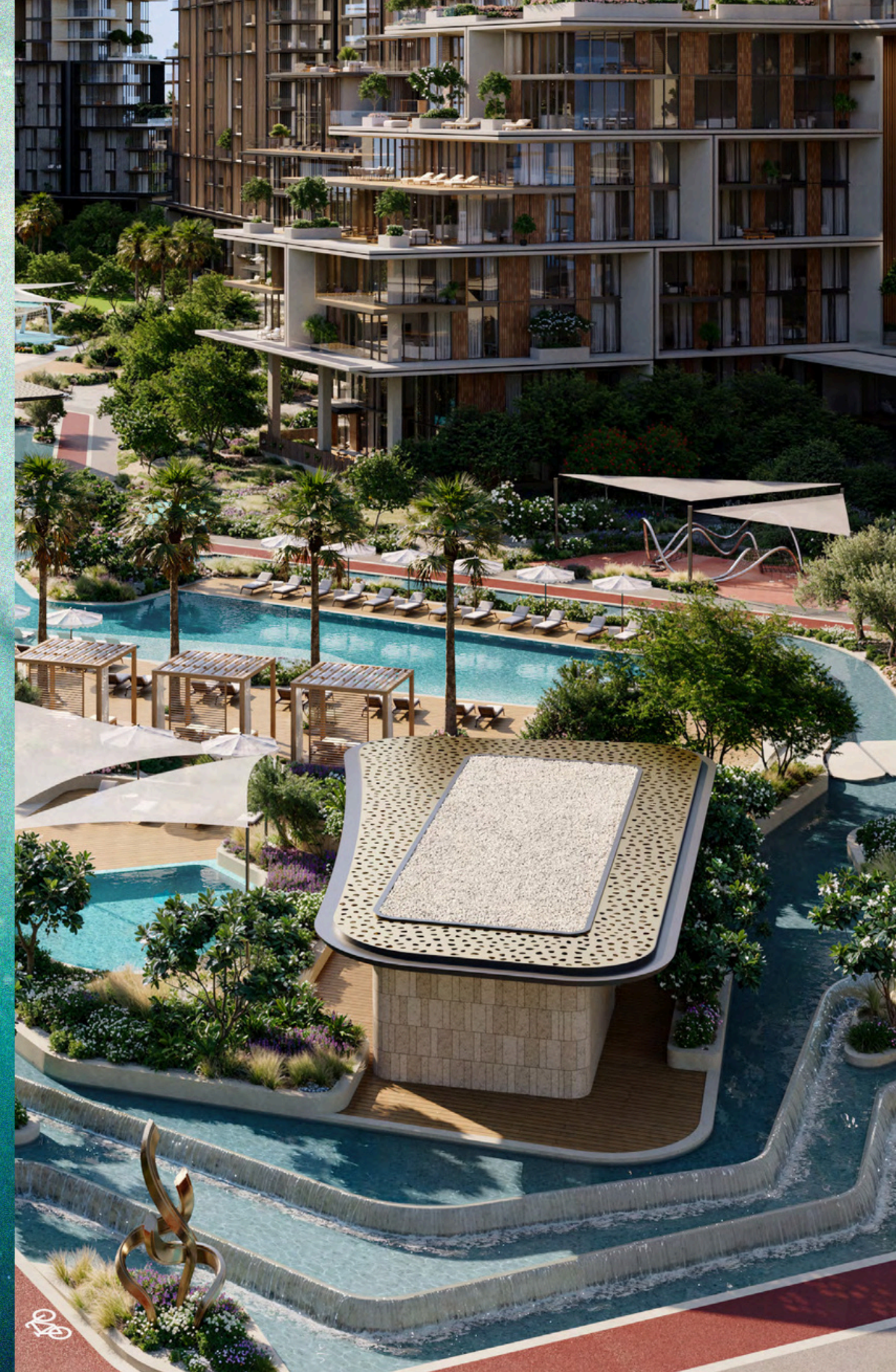

Hit the winding jogging tracks that cut through lush greenery, offering the perfect route to run, walk, or just vibe with the outdoors. Dedicated cycling

lanes curve with the terrain, giving both fitness enthusiasts and casual riders a chance to enjoy the community's vibrant, natural energy.



ACTIVE TRACKS



SPORTS COURTS



Experience world-class Padel and Tennis Courts, where casual games meet intense competition, set in a vibrant, dynamic outdoor environment that pulses with energy.

EVENT LAWNS



Set the stage on the Event Lawns for unforgettable gatherings, from community events to exclusive celebrations, where the energy comes alive.



SUNKEN LOUNGES



Immerse yourself in the serenity of sunken seating nestled in water, offering a peaceful retreat amidst lush surroundings.

WATER THEATRE

C
I
N
E
M
A



Experience movies like never before, with a stunning waterside backdrop that takes every screening to the next level.

PLAY AREAS



Discover an engaging corner where children can explore, play, and learn with interactive equipment and creative play zones.



Step into a breathtaking double-height lobby, where the entrance itself makes a bold statement. With panoramic views of the community, this space defines the dynamic living experience that awaits.

A STATEMENT IN
EVERY DETAIL



FEEL THE VIBE



MOVE WITH THE CITY



Experience outdoor spaces that pulse with life and connection. These terraces are crafted for everything from wellness sessions to lively gatherings. With lush green spaces woven throughout the building, you'll

always find the perfect place to recharge or engage. At the top, the sky deck unfolds panoramic views of the Dubai skyline, bringing the city's energy right to your doorstep.

WHERE FUN

NEVER ENDS



Discover themed indoor kids' play areas in each building, designed to spark creativity and joy. These playful rooms provide children with a safe and exciting environment to explore.



URBAN RESIDENCES



THAT FIT
YOUR FLOW



1 TO 3-BEDROOM APARTMENTS

Experience contemporary living with park-facing and water views, enhanced by thoughtfully designed interiors. Tailored for modern lifestyles, these apartments feature high-quality finishes and spacious layouts that maximise comfort and elegance. Kitchens are sleek and practical, crafted with premium materials, while expansive bedrooms with walk-in closets offer both convenience and sophistication.





CRESTLANE 2
1 TO 3-BEDROOM

LIVING ROOM / DINING



CRESTLANE 2
1 TO 3-BEDROOM

LIVING ROOM / KITCHEN









CRESTLANE 3
1 TO 3-BEDROOM

LIVING ROOM / DINING



CRESTLANE 3
1 TO 3-BEDROOM

LIVING ROOM / KITCHEN



CRESTLANE 3
1 TO 3-BEDROOM

BEDROOM



CRESTLANE 3
1 TO 3-BEDROOM

BATHROOM



SIGNATURE 3 TO 4-BEDROOM APARTMENTS

Step into the signature 3 to 4-bedroom apartments, where bold design meets urban elegance. Double-height living areas lead to expansive park-facing terraces with tranquil water views, offering uninterrupted panoramas and a dramatic sense of space. Select units boast sweeping 180-degree views that bring the city's energy to life. In the 4-bedroom residences, bathrooms are enhanced with striking glass façades that flood the interiors with natural light and create a seamless connection to the city's skyline.



CRESTLANE 2
3 TO 4-BEDROOM

LIVING ROOM / DINING



CRESTLANE 2
3 TO 4-BEDROOM

LIVING ROOM / DINING / KITCHEN





CRESTLANE 3
3 TO 4-BEDROOM

LIVING ROOM



CRESTLANE 3
4-BEDROOM

BEDROOM



CRESTLANE 3
4-BEDROOM

BATHROOM



4-BEDROOM DUPLEXES

Elevate your living experience with the 4-bedroom duplex units, where every detail defines luxury. Double-height living areas flow effortlessly onto private terraces with direct park access and serene water views, blurring the lines between indoors and outdoors to create a perfect blend of style, functionality, and modern living. Exclusive private lift access from designated parking ensures privacy, while bright, expansive interiors amplify the sense of boundless space.















CRESTLANE 3
4-BEDROOM DUPLEXES

LIVING ROOM





IHR DEUTSCHER IMMOBILIENMARKLER INKLUSIVE RECHTSBERATUNG IN DUBAI



Für ein Beratungsgespräch buchen Sie sich jetzt Ihren Termin:

KOSTENLOSES ERSTGESPRÄCH

CANALETTO SKY
REAL ESTATE

Hier geht's zu unserer Webseite:

CANALETTO SKY REAL ESATE LLC

dubai@canalettosky.com

+971 56 589 1112